

# Eclipse Pendant

STARMAN  
TRENDSETTERS

By TrendSetter Mónika Szatmári

Copyright 2017 © Starman, Inc. & Artist. Not licensed for digital distribution.  
Promotional use only—no resale of instructions permitted. Version 1.0

## INTRODUCING THE CZECHMATES® 3-HOLE BEAM™, 2-HOLE CABOCHON, AND THE STARMAN PRONG™

Combine these three new shapes to create this stunning, dimensional pendant.

### ABOUT THE ARTIST: MÓNIKA SZATMÁRI



I was born in Budapest, Hungary, and currently live in Munich, Germany. I fell in love with beads more than five years ago, and it is the biggest passion of my life. I followed patterns at the beginning but now I create my own ideas. I love the freedom of creating, where I can do whatever I want. Visit [www.Etsy.com/Shop/MonikaBeads](http://www.Etsy.com/Shop/MonikaBeads)



**COLORWAYS**—White: Beam Bronze (397-210-90215); CzechMates Cab White (396-06-10300); English Cut Sueded Gold Milky Pink (323-03-MSG71010); Prong Bronze (395-35-90215); TOHO 11° Bronze (TR-11-221); TOHO 15° PF Starlight (TR-15-PF557). Pink: Beam Silver (397-210-27000); CzechMates Cab Opq. Rose/Gold Topaz (396-06-P65491); English Cut Silver (323-03-27000); Prong Silver (395-35-27000); TOHO 11° Nickel (TR-11-711); TOHO 15° PF Starlight (TR-15-PF557). Turquoise: Beam Dk Bronze (397-210-14415); CzechMates Cab Mitt. Turquoise (396-06-M6313); English Cut Matte Bronze Copper (323-03-K0178); Prong Dk Bronze (395-35-14415); TOHO 11° Gold-Luster Montana Blue (TR-11-204); TOHO 15° Round PF Starlight (TR-15-PF557).

### MATERIALS

- 10 CzechMates® Beam (CB)
- 10 CzechMates® Cabochon (CC)
- 10 English Cut, 3mm (E3)
- 20 Prong 3/5mm (P)
- 1g 11° TOHO Seed Beads (S11)
- 1g 15° TOHO Seed Beads (S15)
- Fireline, Wildfire, or Nanofil
- Necklace Chain of Choice

Pendant as instructed measures 1.5" wide before ball and chain.

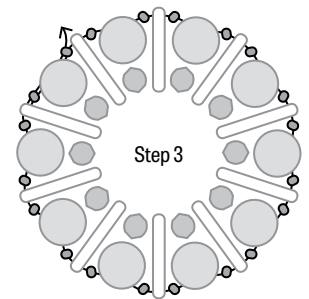
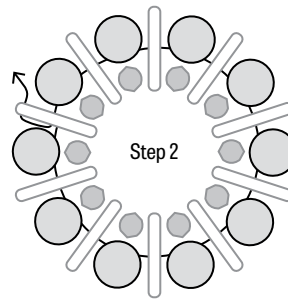
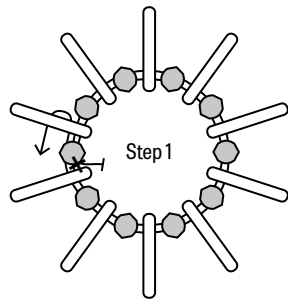

### INSTRUCTIONS

1. On 1.5yd of thread, add E3, CB. Repeat this nine times. Form a ring and tie a knot against the tail, leaving some wiggle room between beads. Pass through all beads again. Pass through the first CB, then jump to the center hole.
2. Add CC, then pass through the middle hole of the next CB. Repeat this step for the entire ring. Ensure that the Cabochons are added in the same orientation. Pass through the center hole of the CB you started at, then jump to the remaining open hole.
3. Add S15, then pass through the open hole of CC. Add S15 then pass through the open hole of CB. Repeat this step for the entire ring. Pass through S15, CC, S15.
4. Flip the piece over to work on the back. Add three S15, skip over the CB, then pass through the next S15. Add P, S11, P, then pass through the next S15. Add the Prongs so that their points are facing toward each other. The Prongs should sit beneath the flat bottom of the Cabochon. Repeat this step for the entire ring. After adding the last Prong, pass through five S15, P, S11.
5. Add five S11, pass through the next S11. Repeat this step for the entire ring. Pass through all beads again twice. Continue passing through three S11 added in this step.
6. **Square Stitch Bail:** a) Add two S11, pass through the S11 you started at, and the first S11 just added. b) Add two S11, pass down through one S11 then up one S11 in the adjacent column. Repeat Step 6b 13 times. c) Pass through the S11 on the ring you started at to form a loop. Reinforce the connection before tying off. [Not Shown]

